

1-Line , Uni-directional , Transient Voltage Suppressor

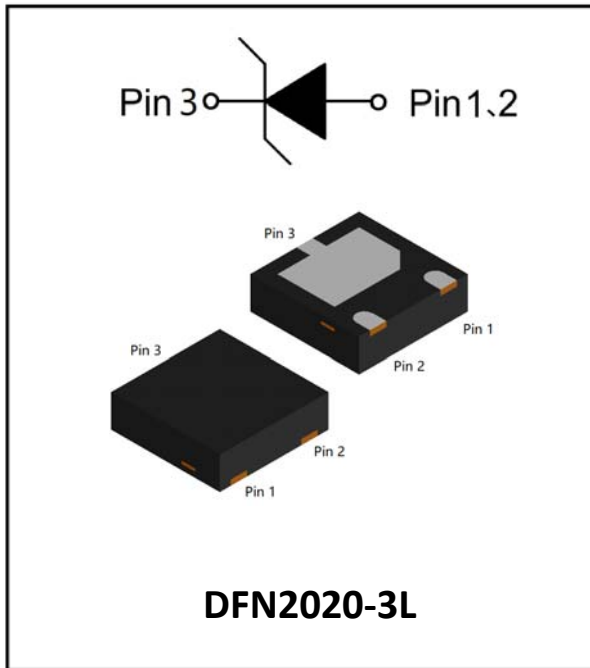

Features

- Ultra small package
- Stand-off voltage: 10V ~24V
- Transient protection for each line according to
 - IEC61000-4-2(ESD): $\pm 30\text{kV}$ (contact)
 - IEC61000-4-4 (EFT): 80A (5/50ns)
 - IEC61000-4-5(surge)
- Low clamping voltage
- RoHS Compliant

Applications

- Power supply protection
- Power management
- Battery Contacts

Mechanical Characteristics

- Package: DFN2020-3L
- Case Material: "Green" Molding Compound.
- Moisture Sensitivity: Level 3 per J-STD-020
- Marking Information: See Below



5101= Series code
VXX = Device code

Device	Device code
ESD10VP4A	V10
ESD12VP4A	V12
ESD15VP4A	V15
ESD18VP4A	V18
ESD24VP4A	V24

■Definitions of electrical characteristics

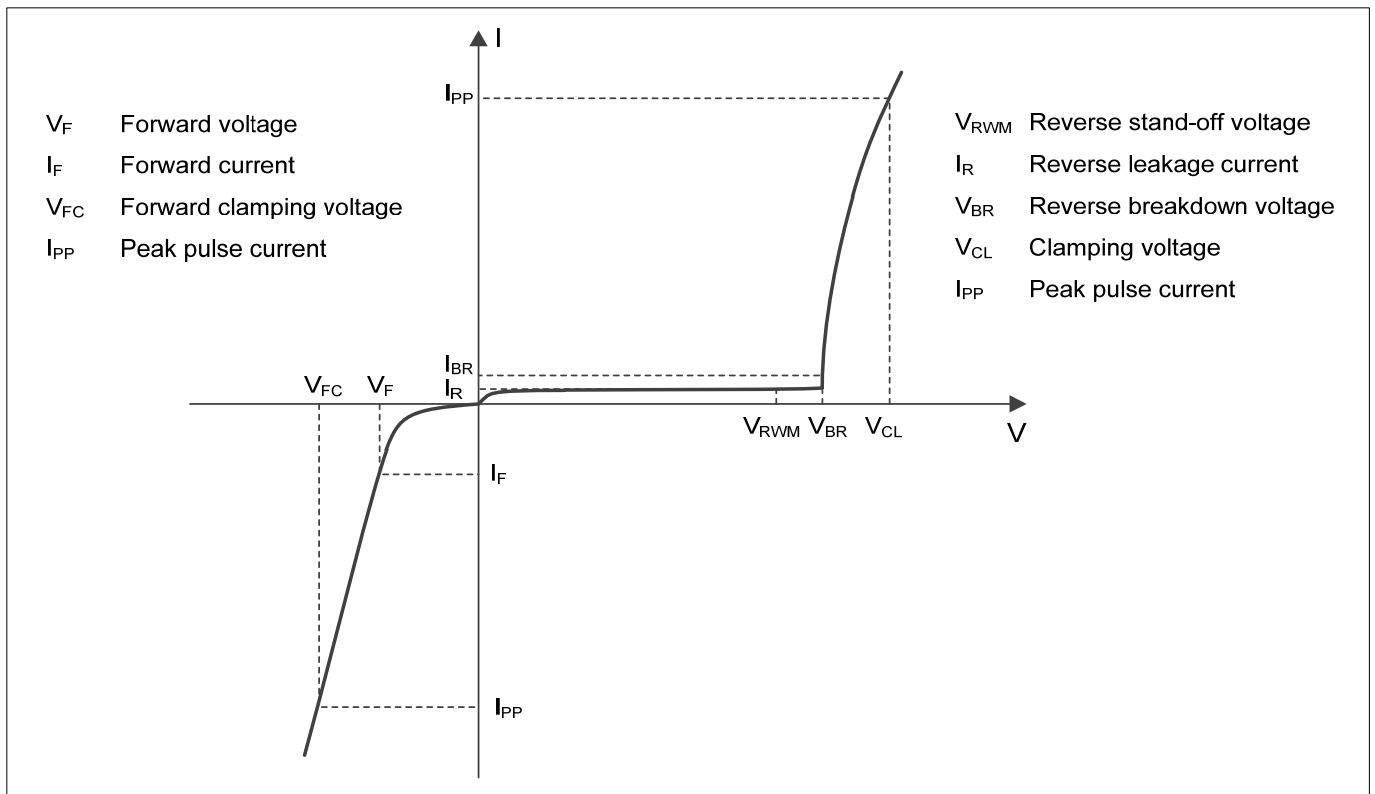



ESD10VP4A THRU ESD24VP4A

■Absolute Maximum Ratings (Ta=25°C unless otherwise specified)

PARAMETER	SYMBOL	VALUE	UNIT
Peak pulse power ($t_p = 8/20\mu s$)	P_{pk}	4500	W
ESD according to IEC61000-4-2 air discharge	V_{ESD}	± 30	KV
ESD according to IEC61000-4-2 contact discharge		± 30	KV
Junction temperature	T_J	-55~125	°C
Operating temperature	T_{OP}	-40~85	°C
Storage Temperature Range	T_{STG}	-55~150	°C

■Electrical Characteristics (Ta=25°C Unless otherwise specified)

Part Number	Reverse Working Voltage $V_{RWM}(V)$	Breakdown Voltage $V_{BR}(V)@I_T=1mA$			Reverse Leakage Current $I_R(\mu A)@V_{RWM}$		Forward Voltage $V_F(V)@I_F=20mA$		Junction Capacitance $C_j(pF)@VR=0V, f=1MHz$	
	Max	Min	Typ	Max	Typ	Max	Min	Max	Typ	Max
ESD10VP4A	10	10.5	11.0	12.5	-	1	0.45	1.25	2150	2600
ESD12VP4A	12	12.5	13.0	15.0	-	1	0.45	1.25	1650	2000
ESD15VP4A	15	15.5	16.5	18.0	-	1	0.45	1.25	1250	1500
ESD18VP4A	18	18.5	19.5	21.0	-	1	0.45	1.25	1000	1200
ESD24VP4A	24	24.5	26	28	-	1	0.45	1.25	800	1000

Part Number	Rated peak pulse current IPP (A) ¹⁾	Clamping voltage VCL(V) @ IPP (A) ¹⁾	
	Max	Typ	Max
ESD10VP4A	205	19	21
ESD12VP4A	200	22	24
ESD15VP4A	160	26	28
ESD18VP4A	150	31	33
ESD24VP4A	120	36	38

Notes:

(1). Non-repetitive current pulse, according to IEC61000-4-5. (8/20μs current waveform).

■Ordering Information (Example)

PREFERRED P/N	UNIT WEIGHT(mg)	MINIMUM PACKAGE(pcs)	INNER BOX QUANTITY(pcs)	OUTER CARTON QUANTITY(pcs)	DELIVERY MODE
ESD10VP4A THRU ESD24VP4A	Approximate 10	3000	30000	120000	Tape & reel



ESD10VP4A THRU ESD24VP4A

■ Typical Performance Characteristics ($T_A=25^\circ\text{C}$ unless otherwise Specified)

8/20 μs waveform per IEC61000-4-5

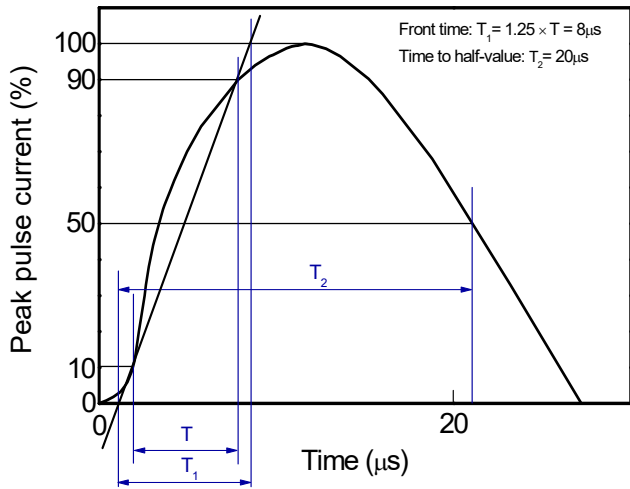

Contact discharge current waveform per IEC61000-4-2

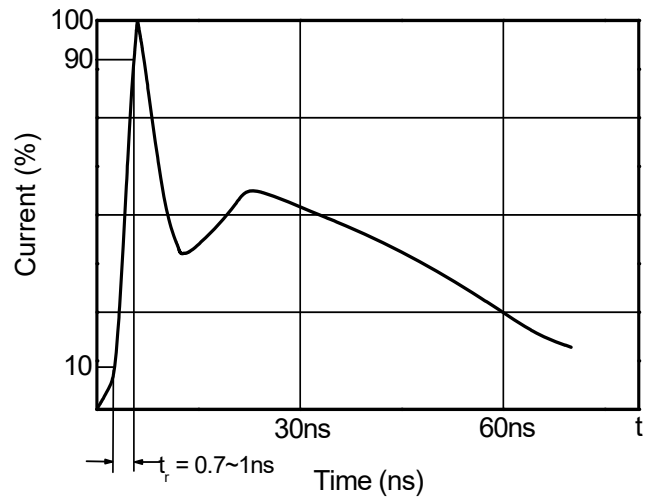

Clamping voltage vs. Peak pulse current

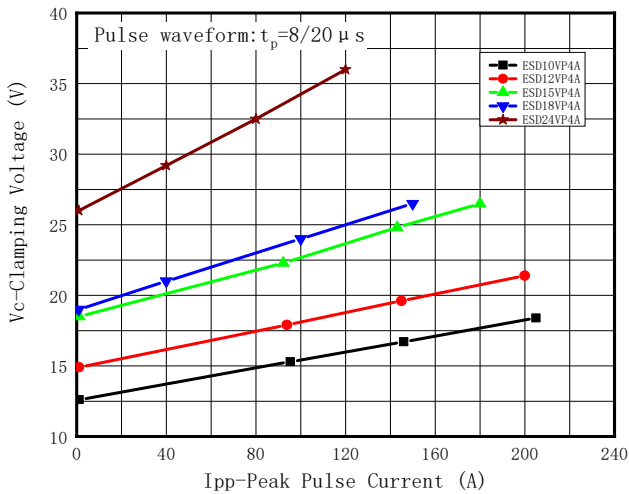

Non-repetitive peak pulse power vs. Pulse time

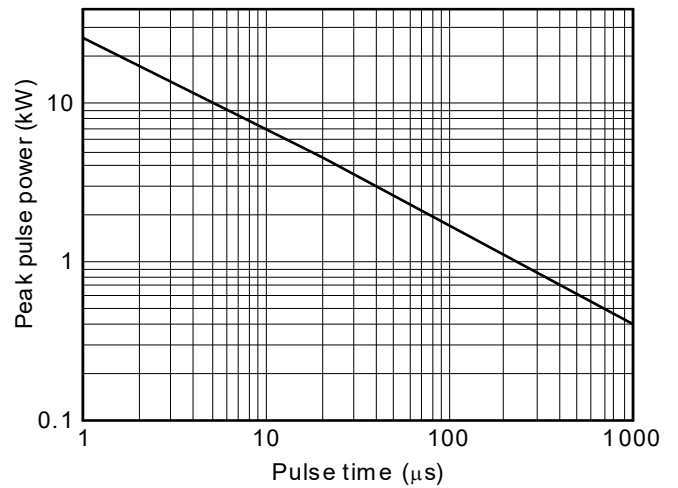

Power derating vs. Ambient temperature

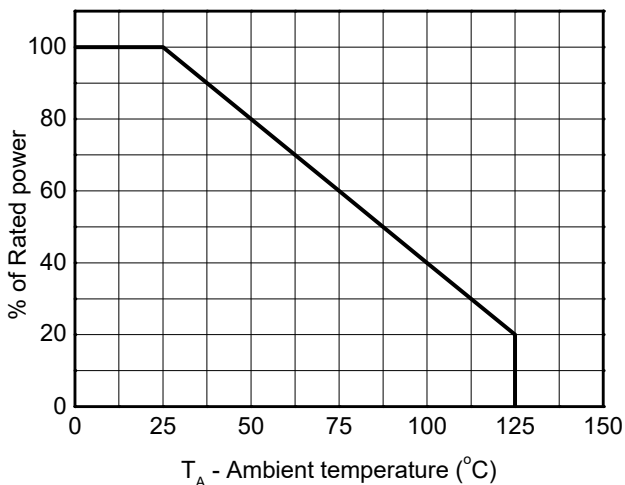



ESD10VP4A THRU ESD24VP4A

■ Outline Dimensions

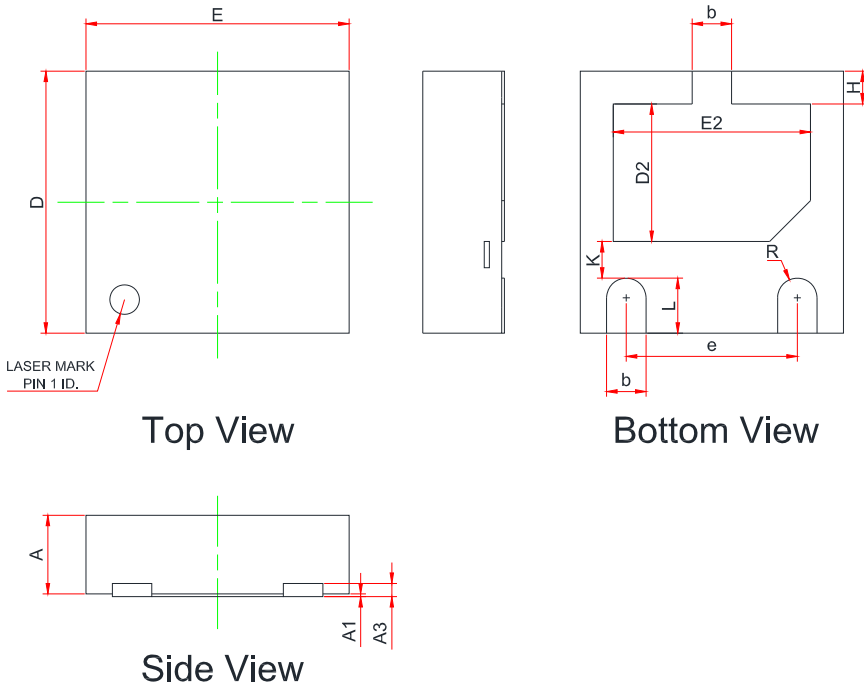

Symbol	Dimensions In Millimeters		
	Min.	Typ.	Max.
A	0.55	0.60	0.65
A1	0.00	0.02	0.05
A3	0.10 REF.		
b	0.25	0.30	0.35
D	1.90	2.00	2.10
E	1.90	2.00	2.10
D2	0.95	1.05	1.15
E2	1.40	1.50	1.60
e	1.20	1.30	1.40
H	0.20	0.25	0.30
K	0.20	0.30	0.40
L	0.35	0.40	0.45
R	0.13	-	-

■ Recommend land pattern (Unit:mm)

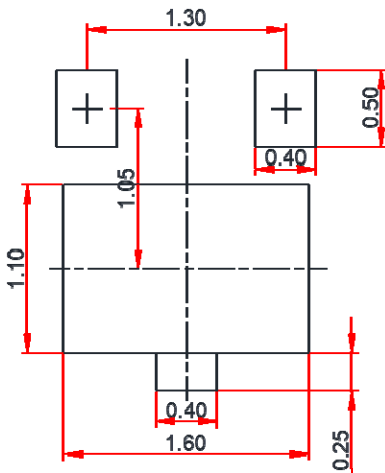

Notes:

This recommended land pattern is for reference purposes only. Please consult your manufacturing group to ensure your PCB design guidelines are met.



ESD10VP4A THRU ESD24VP4A

Disclaimer

The information presented in this document is for reference only. Yangzhou Yangjie Electronic Technology Co., Ltd. reserves the right to make changes without notice for the specification of the products displayed herein to improve reliability, function or design or otherwise.

The product listed herein is designed to be used with ordinary electronic equipment or devices, and not designed to be used with equipment or devices which require high level of reliability and the malfunction of which would directly endanger human life (such as medical instruments, transportation equipment, aerospace machinery, nuclear-reactor controllers, fuel controllers and other safety devices), Yangjie or anyone on its behalf, assumes no responsibility or liability for any damages resulting from such improper use of sale.

This publication supersedes & replaces all information previously supplied. For additional information, please visit our website [http:// www.21yangjie.com](http://www.21yangjie.com) , or consult your nearest Yangjie's sales office for further assistance.